



ENGLISH  
GT350

# Quick Start Guide

Visit [http://ca.lgservice.com/index\\_b2c.jsp](http://ca.lgservice.com/index_b2c.jsp) for the User Guide fully illustrated on how to use your phone.

P/N : MCDD0000000 (1.0) G  
Printed in Korea

## Your Phone

### Part of the phone

- Handsfree or Stereo earphone connector**
- Power/Lock key**
  - Long press for power on/off.
  - Short press to turn on/off the screen.
- End key**
- Call key**
  - Dials a phone number and answers incoming calls.
- Multitasking key**
- Charger, USB cable**
- Camera key**
- Micro SD memory card socket**
- Side keys**
  - **When the screen is at the Home screen:** Ring tone and key tone volume.
  - **During a call:** During a call, side keys change the talking volume volume.

### Open view

- Change the text input mode (capital/ small)**
- SMS**
- Alpha numeric keys**
- Symbol key**
  - Enters symbolic characters
- Space key**
  - Use to enter a space when editing.
- Social Network**
- Internet Full Browsing**
- Push E-mail**
- Instant Messenger**
- Enter key**
- Clear key**
  - Clears a character each time it is pressed. Hold the key down to clear all input.

**WARNING:** Placing a heavy object on the phone or sitting on it while it is in your pocket can damage the phone's LCD and touch screen functionality.

## Getting Started

### Installing the SIM and battery

#### 1 Remove the battery cover

Slide the battery cover towards the bottom of the phone and away from it.



#### 2 Install the SIM card

Slide the SIM card into the SIM card holder making sure that the gold contact area on the card is facing downwards. Please make sure the battery is removed from the phone before installing the SIM card. To remove the SIM card, pull it gently outwards.

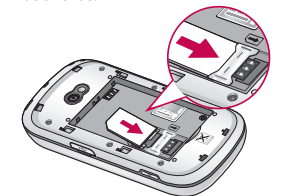

**WARNING:** Do not use your fingernail to remove the battery.

**WARNING:** Do not remove the battery when the phone is switched on, as this may damage the phone.

#### 3 Install the battery

Insert the left side of the battery into the top edge of the battery compartment first. Ensure that the battery contacts align with the phone's terminals. Press the right side of the battery until down it clicks into place.

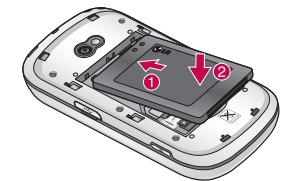

### Charging your phone

Remove the charger socket cover on the side of your GT350. Connect the Travel Adapter (Charger) and the included USB cable. Connect the USB cable into the phone and plug it into a power socket. Your GT350 must be charged until the "Battery full" message appears on the screen.

**NOTE:** The battery must be fully charged initially to improve battery lifetime. Disregard the first "Battery full" message and keep the phone on charge overnight.



### Installing a memory card

You can expand the memory space on your phone by using a MicroSD memory card.  
**NOTE:** A memory card is an optional accessory.

#### 1 Open the memory card slot cover on the left-hand edge of the phone.



#### 2 Slide the memory card into the slot until it clicks into place. Make sure the gold contact area is facing downwards.

### Using your touch screen

#### Touch screen tips

- To select an item, touch the centre of the icon.
- Do not press too hard. The touchscreen is sensitive enough to pick up a light, firm touch.
- Use the tip of your finger to touch the option you require. Be careful not to touch any other keys.
- Whenever your GT350 is not in use, it will return to the lock screen.

#### Scrolling

Drag from side to side to scroll. On some screens, such as the Recent History, you can also scroll up or down.

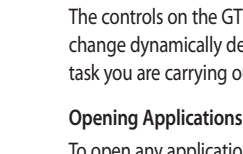

#### Opening Applications

To open any application, simply touch its icon.

### Your home screen

You can drag and click what you need right away in all home screen types.

- Widget home screen**

When you touch on the bottom right of the screen, the mobile widget panel appears. When you select widget and dragging it onto the screen, the widget will appear on the spot where it was dropped.
- Speed dial home screen**

You can call, send a message or edit the contact directly in this home screen. When you touch, the speed dial list appears, and you can drag your speed dials onto the screen.
- Livesquare home screen**

On the Livesquare screen, You can easily make a call and send a message to the number allocated to an avatar. To use the call, messaging or contacts function, select an avatar and choose the Quick key icon you want to use.

#### Control the touch screen

The controls on the GT350 touch screen change dynamically depending on the task you are carrying out.

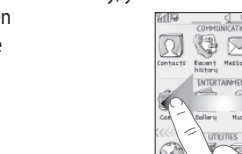

### LIMITED WARRANTY STATEMENT

#### 1. WHAT THIS WARRANTY COVERS:

LG offers you a limited warranty that the enclosed subscriber unit and its enclosed accessories will be free from defects in material and workmanship, according to the following terms and conditions:

1. The limited warranty for the product extends for ONE (1) year beginning on the date of purchase of the product by the original end user.
2. The limited warranty extends only to the original end user of the product and is not assignable or transferable to any subsequent purchaser/end user.
3. This warranty is good only to the original end user of the product during the warranty period as long as it is in Canada.
4. Upon request from LG, the consumer must provide information to reasonably prove the date of purchase.
5. During the applicable warranty period, LG will repair or replace at LG's sole option, without charge to the original end user, any defective component part of the phone or accessory.
6. LG may use rebuilt, reconditioned or new parts or components when repairing any product or replace a product with a rebuilt, reconditioned or new product.

#### 2. WHAT THIS WARRANTY DOES NOT COVER:

1. Defects or damages resulting from use of the product in other than its normal and customary manner.
2. Defects or damages from abnormal use, abnormal conditions, improper storage, exposure to moisture or dampness, unauthorized modifications, unauthorized connections, unauthorized repair, misuse, neglect, abuse, accident, alteration, improper installation or other acts which are not the fault of LG, including damage caused by spills of food or liquids.
3. Breakage or damage to antennas unless caused directly by defects in material or workmanship.
4. The fact that the Customer Service Department at LG was not notified by the original end user of the alleged defect or malfunction of the product, during the warranty period.
5. Products which have had their serial numbers removed or made illegible.

#### 3. EXCLUSION OF LIABILITY:

No other express warranty is applicable to this product. THE DURATION OF ANY IMPLIED WARRANTIES INCLUDING THE IMPLIED WARRANTY OF MARKETABILITY, IS LIMITED TO THE DURATION OF THE EXPRESS WARRANTY HEREIN. LG ELECTRONICS CANADA, INC. SHALL NOT BE LIABLE FOR THE LOSS OF THE USE OF THE PRODUCT, INCONVENIENCE, LOSS OR ANY OTHER DAMAGES, DIRECT OR CONSEQUENTIAL, ARISING OUT OF THE USE OF, OR INABILITY TO USE, THIS PRODUCT OR FOR ANY BREACH OF ANY EXPRESS OR IMPLIED WARRANTY, INCLUDING THE IMPLIED WARRANTY OF MARKETABILITY APPLICABLE TO THIS PRODUCT.

#### 4. HOW TO GET WARRANTY SERVICE:

To obtain warranty service, please call the following telephone number from anywhere in Canada:  
LG Electronics Canada, Inc.  
Tel. 1-888-542-2623  
[www.lg.ca](http://www.lg.ca) (see links to "Wireless Phone Service")

#### 6. Damage resulting from use of non-LG approved accessories.

7. All plastic surfaces and all other externally exposed parts that are scratched or damaged due to normal customer use.

#### 8. Products serviced by non-authorized persons or companies.

#### Notes:

1. This limited warranty supersedes all other warranties, expressed or implied either in fact or by operations of law, statutory or otherwise, including, but not limited to any implied warranty of merchantability or fitness for a particular purpose.

2. Shipping damage is the sole responsibility of the shipping company.

#### TIP! The User Interface is based on three types of Homescreen. To swap between the home screens just wipe quickly over the display from left to right, or from right to left.

9. LG Electronics Canada Inc. Mississauga, Ontario